

Swiss technology and quality



The submicron is our business!

PRETEC is leading and well established Swiss manufacturer supplying standard or customized products and systems in the dimensional metrology for more than forty years.

PRETEC electronic measuring probes can be characterized as being Swiss technology, quality and high precision. PRETEC products offer a unique compatibility and modularity concept with other probes manufacturers. Our large product range will for sure covers your application needs. A large choice of accessories and options are as well available whether as standard or customizable.

PRETEC electronic measuring probes benefits

Compatibility	PRETEC probes integrate 2 sensitivities: PRETEC or TESA/others manufacturers! This is a standard feature on all our probes. Free yourselves from one brand!
Force setup	Inside spring replacement to change the measuring force to adapt to your application need is possible. This is an optional feature.
Travel setup	The travels set up is adjusted from the exit cable side! This is our insurance that you can perform the adjustments in any situation!
Cable exit	Our probes 2940/2924 allow axial or radial cable exit and avoid the hassles of ordering and stocking two types of probes. With a simple clip!
Cable length	Cable length is up to your application need. Our standard length is 2 m, but supply of up to 20 m in PUR is possible. This is an optional feature.
Accessories	Our accessories program range is substantial. Tailor-made accessories are as well available. Just call us!
Customisation	Let us talk if you need customized electronic measuring probes.

Our electronic measuring probes features

- Compatible with other manufacturers (TESA, etc.)
- Φ 8h6 mm probe stainless steel carbide-chromed housing
- Axial or radial cable exit
- Measuring bolt guided on ball bearing (except 2952)
- Special roller bearing locks the probe head against torsion
- Mechanical or vacuum retraction
- Pre/Post-travel setup from the back of the probe
- Wide range of accessories available

Products range and specification

Technical specification

Order Number	Measuring travel A1	Working Travel A2	Overall travel A3	Repeatability typical	Linearity	Hysteresis Error	Measuring force on zero point	Protection	Cable	Application
2921	±0.8 mm	0.8 – 1.1 mm	3 mm	< 0.02 µm	±0.3 %	< 0.02 µm	0.6..1.0 N	IP66	2 m - Axial	Splash waterproof
2922	±1 mm	1.1 – 1.2 mm variable	3 mm	< 0.02 µm	±0.3 %	< 0.02 µm	0.45..0.75 N	IP64	2 m – Radial	Vacuum lift
2924	±1 mm	1.1 – 1.3 mm Fix	3 mm	< 0.02 µm	±0.3 %	< 0.02 µm	0.45..0.75 N	IP65	2 m – Axial	Splash waterproof
2940	±2 mm	1.1 – 1.3 mm variable	4.2 mm	< 0.02 µm	±0.3 %	< 0.02 µm	0.45..0.75 N	IP64	2 m – Axial and radial	Universal
2970	±3 mm	3.5 mm Fix	7 mm	< 0.5 µm	±2 %	< 0.5 µm	0.8..1.2 N	IP64	2 m – Axial	Large measuring range
2952	±1 mm	1.05 – 1.1 mm Fix	2 mm	0.01 -0.05 µm	±0.3 %	< 0.02 µm	0..0.25 N	IP64	2m - Axial	Low measuring force

Electrical/Environment

Nominal sensitivity	Zero drift	Operating temperature	Maximum relative humidity
73,5 mV/mm	0.15 µm/°C	-10..+65 °C	80%

Materials

Housing	Contact point	Sealing bellows	Male cable connector	Cable
Stainless steel carbide chromed	M 2.5 Carbide tungsten	Nitrile (Viton optional)	DIN 4532 without pin 6	2 m (available in bigger size in PUR as option)

*14 to 20 m cable length will affect the output electrical signal by a minimum of 2% loss

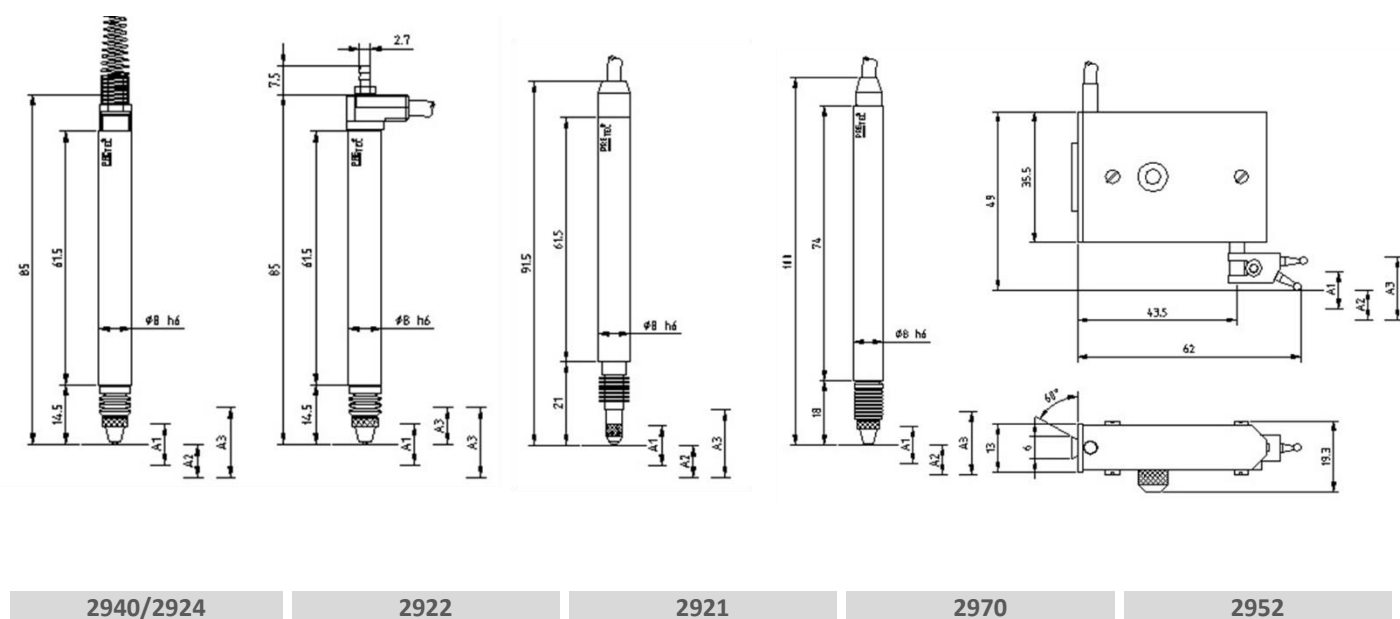

2940/2924

2922

2921

2970

2952

Standard accessories product range

Contact points M2.5 for	Cable extension with 2 connectors for all probes 1910.500	Accessories for 2952
2920, 2921, 2922, 2940, 2970 Standard, knife edge, pin, carbide ball, roller bearing See drawings here below	Each meter from 1 m (1910.500.1) to 20 m (1910.500.20)	1950.310 : probe holder 1960.200 : styli 9 mm length 1960.210 : styli 33 mm length

*Customized accessories are available upon request

RT 130

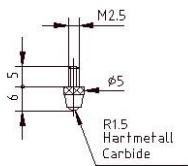

RT 131

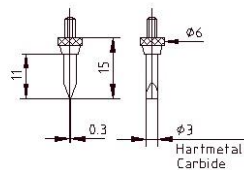

RT 132

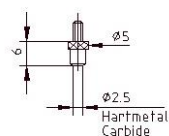

RT 133

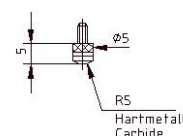

RT 134

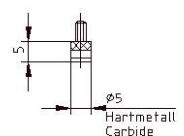

RT 135

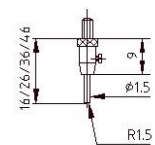

RT 136

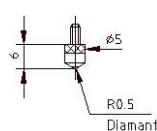

RT 137/...

Type	L
RT 137/10	10
RT 137/15	15
RT 137/20	20
RT 137/30	30

RT 138

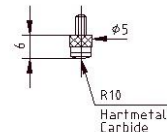

RT 140

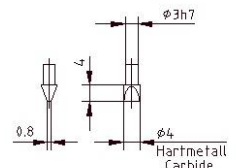

Industrial applications

- Automobile ● Aircraft ● Aerospace ● Machine tools ● Medical ● Watch ● Electronic
- Bearings ● Defense ● Turnkey projects

PRETEC products and services

- Electronic comparators ● Electronic measuring probes ● Electronic bore gages
- Air electronic converters ● Air plugs and rings ● Measuring computers ● SPC software
- Custom design fixtures ● Engineering projects ● Training



Products ● Solutions ● Services

Modification rights reserved